



**GOW**  
Services

INSTALLATION DECK BALAM-TA2



# Our Company



Engineering services for the construction industry of oil & gas facilities and the petrochemical sector.



*Development of basic and detailed engineering, as well as 3D modeling for the ESEASA OFFSHORE BALAM-TA2 platform (2021).*

Founded in 2007, we provide comprehensive engineering solutions for the oil & gas and petrochemical industries.

Our team has extensive experience in conceptual, basic, and detailed engineering, allowing us to efficiently address complex projects.

We specialize in 3D modeling to optimize visualization and project planning.

With a management system based on ISO 9001:2015, we ensure quality at every stage, from design through supervision.

Our commitment to technological innovation and adaptation to industry needs positions us as a leader in industrial and infrastructure projects, integrating advanced technology to develop highly complex solutions.

We maintain an extensive library of national and international technical standards, including current and applicable PEMEX regulations, which are applied to all projects according to their specific requirements.

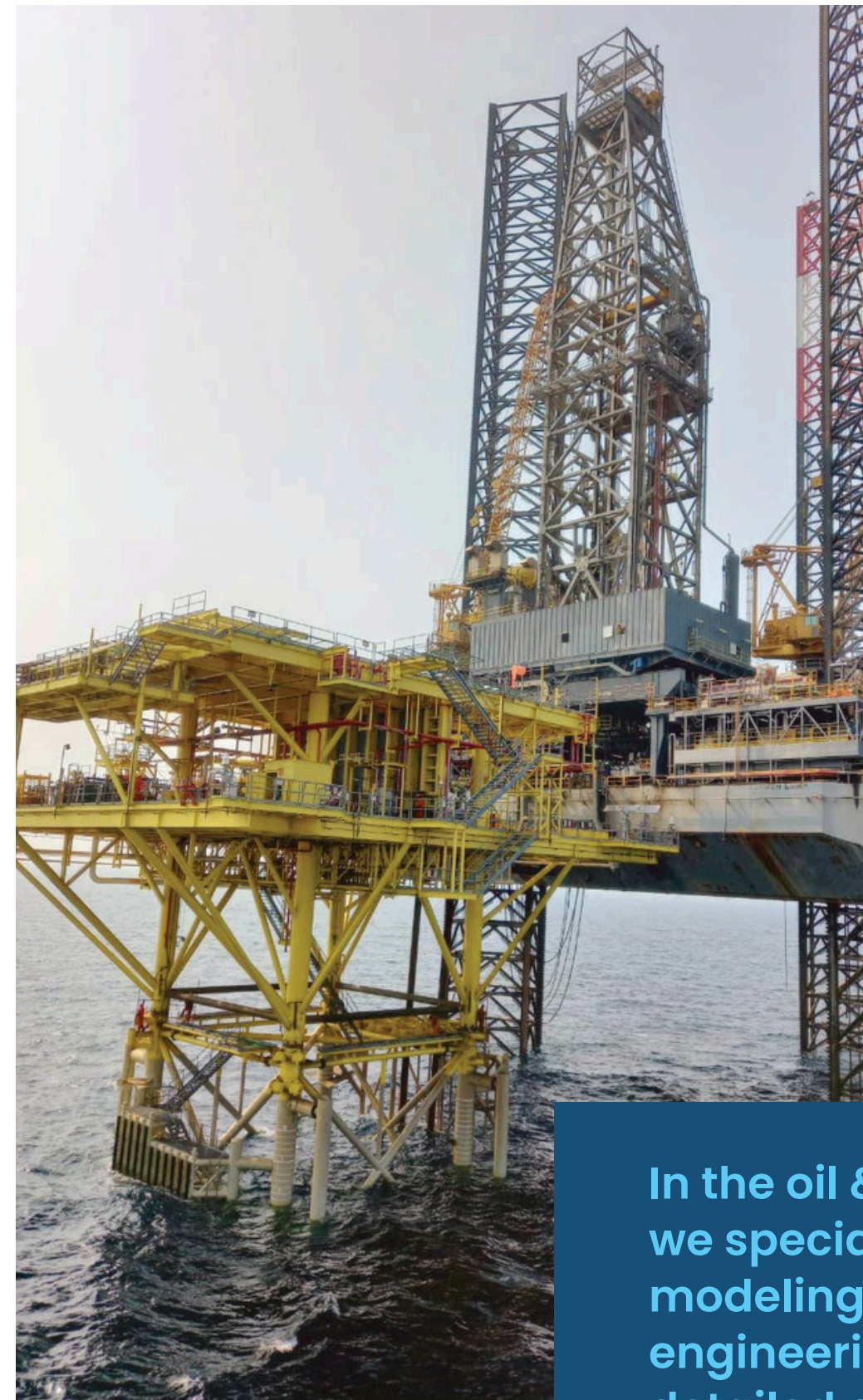

*Development of basic and detailed engineering, as well as 3D modeling for the ESEASA OFFSHORE XIKIN-B platform (2019).*



Professional team of engineers and technicians, combining creativity, experience, and both theoretical and practical expertise to develop competitive, high-quality projects with reliable results.

We provide comprehensive consulting, cutting-edge technology, and a strong commitment to safety.

**In the oil & gas sector, we specialize in 3D modeling, basic engineering, and detailed engineering.**



# Our Mission & Vision



Trust, Integrity, Transparency, Loyalty, Ethics, Respect, Responsibility, Credibility, Success, Strength.

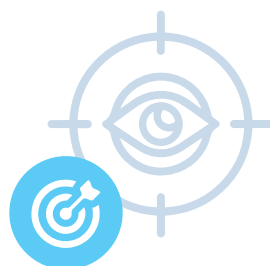

## Our Vision

To be a leading company in industrial process engineering, capable of meeting national demand while maintaining mutual loyalty with our clients, partners, and collaborators.



## Our Mission

To provide engineering services to the oil & gas construction industry and the petrochemical sector, with a strong focus on quality and added value.



## Our Values

Respect	Loyalty
Service	Discipline
Honesty	Positive Attitude

ESEASA Yard. Design, construction, transportation, and installation of seven offshore platforms. GOWSM developed the basic and detailed engineering, as well as the 3D modeling for all platforms.



We are leaders in industrial process engineering, meeting national and international demand with strong commitment to our clients, partners, and collaborators.



## Additional Services

We have an extensive network of independent specialists to support the development of engineering disciplines.

We also provide complementary support services for engineering development.

[Access portfolio](#)



## Library

- All PEMEX regulations
- National standards  
[Access document](#)
- International standards  
[Access document](#)
- Available software  
[Access document](#)
- Reference projects

Load-out, mooring, and transportation of the XIKIN-B topside, part of the ESEASA seven-platform project.

[Click to watch video](#)

We work in compliance with a broad range of national and international technical standards, including all applicable PEMEX regulations, ensuring their implementation across projects according to specific technical requirements.





# Precision in Service



Confidence in Results

Marine Infrastructure Unit  
BALAM-TA2 (DECK)

## Our services

With experience in conceptual, basic, and detailed engineering, we also provide advanced 3D modeling solutions.

We develop customized projects, deliver certified training for offshore platforms and industrial facilities, supply specialized technical personnel through specialized services (REPSE), and ensure high operational standards.



### Engineering and 3D Modeling

Our personnel has extensive experience in the development of conceptual, basic, and detailed engineering.

As well as shop engineering and 3D modeling.



### External Management

To maintain operational standards, we provide specialized technical personnel supervised by our client.

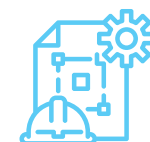

### Adaptive Engineering

Engineering of process package equipment developed using proprietary technology.

For each specific case, we generate the supporting documentation corresponding to basic and detailed engineering.



### Training Courses

Preparation and delivery of training programs, including registration with the STPS.

Our certified instructors develop and deliver courses for teams involved in offshore platforms and industrial facilities.



# Our OFFSHORE & ONSHORE Projects



WELL  
DRILLING



UPSTREAM



ADVANCED  
SOLUTIONS



POWER  
GENERATION





RESERVOIR  
MANAGEMENT



MIDSTREAM



2018

 Client: DRAGADOS OFFSHORE  
 Location: North Sea  
 Country: Spain

DOSA has been awarded the design, construction, and installation contracts for multiple power generation platforms through offshore wind energy, including the BorWin 5, DorWin 4 / BorWin 4, DolWin 6, BalWin 1 and 2 platforms, among others. GOWSM has collaborated by providing administrative support personnel, 3D model development, and shop engineering for multiple disciplines, from 2018 to the present. To date, approximately 50,000 engineering man-hours (HH) have been executed.



2019

 Client: ESEASA OFFSHORE  
 Location: Bay of Campeche, Gulf of Mexico  
 Country: Mexico

Development of basic and detailed engineering using MEBI/METI, process risk analysis (ARP), and technical assistance during procurement, construction, and installation of a package of seven offshore platforms (XIKIN-B, SUUK-A, POKCHE-A, TETL-A, CAHUA-A, OCTLI-A, TEEKIT-A), ELM-tetrapod type, designed to recover up to nine wells, in water depths ranging from 26 to 45 meters, to be installed in the Campeche Sound, Gulf of Mexico. Approximately 300,000 engineering man-hours (HH) were executed.



2020

 Client: ESEASA OFFSHORE  
 Location: Bay of Campeche, Gulf of Mexico  
 Country: Mexico

Development of basic and detailed engineering using MEBI/METI, process risk analysis (ARP), and technical assistance during procurement, construction, and installation of the BALAM-TA2 offshore platform, including the interconnection bridge. Additionally, in 2021, the control room for the BEC system (Electrical Submersible Pumping) was designed for installation in the Campeche Sound, Gulf of Mexico. Approximately 100,000 engineering man-hours (HH) were executed.



# Our OFFSHORE & ONSHORE Projects



WELL  
DRILLING



UPSTREAM



ADVANCED  
SOLUTIONS



POWER  
GENERATION



RESERVOIR  
MANAGEMENT



MIDSTREAM



2020

 Client: ESEASA OFFSHORE  
 Location: Bay of Campeche, Gulf of Mexico  
 Country: Mexico

Development of design basis, basic and detailed engineering for the project titled: Engineering, procurement, and construction of the Marine Infrastructure Unit (UIM-16), to be installed in the Bay of Campeche, Gulf of Mexico Approximately 120,000 engineering man-hours (HH) were executed.





2020

 Client: ESEASA OFFSHORE  
 Location: Bay of Campeche, Gulf of Mexico  
 Country: Mexico

Development of design basis, basic and detailed engineering for the project titled: Engineering, procurement, and construction of the Marine Infrastructure Unit (UIM-21), to be installed in the Bay of Campeche, Gulf of Mexico Approximately 100,000 engineering man-hours (HH) were executed.



2021

 Client: ESPECIALIDADES EN TURBOMAQUINARIA (ETM)  
 Location: Agua Dulce, Veracruz  
 Country: Mexico

Development of design engineering and complementary services for the project titled: Engineering, procurement, and construction, testing, and commissioning of the production handling infrastructure at the RABASA separation battery (Second Phase). Approximately 180,000 engineering man-hours (HH) were executed.



# Our OFFSHORE & ONSHORE Projects



📍 Client: METALMECÁNICA DEL GOLFO (MEGSA)  
📍 Location: Puerto Rosales  
🌐 Country: Argentina

Update of basic engineering and development of detailed engineering for the civil/architectural and electromechanical disciplines of the IPC, for the expansion of the Oiltanking America (OTA) Fuel Storage and Transfer Terminal in Puerto Rosales, Argentina. Project currently under development, approximately 175,000 engineering man-hours (HH).



WELL  
DRILLING



UPSTREAM



ADVANCED  
SOLUTIONS



POWER  
GENERATION



RESERVOIR  
MANAGEMENT



MIDSTREAM



Development and update of basic and detailed engineering for the OTA fuel storage terminal in Puerto Rosales, Argentina.

▶ [Click to watch video](#)



# Our OFFSHORE & ONSHORE Projects

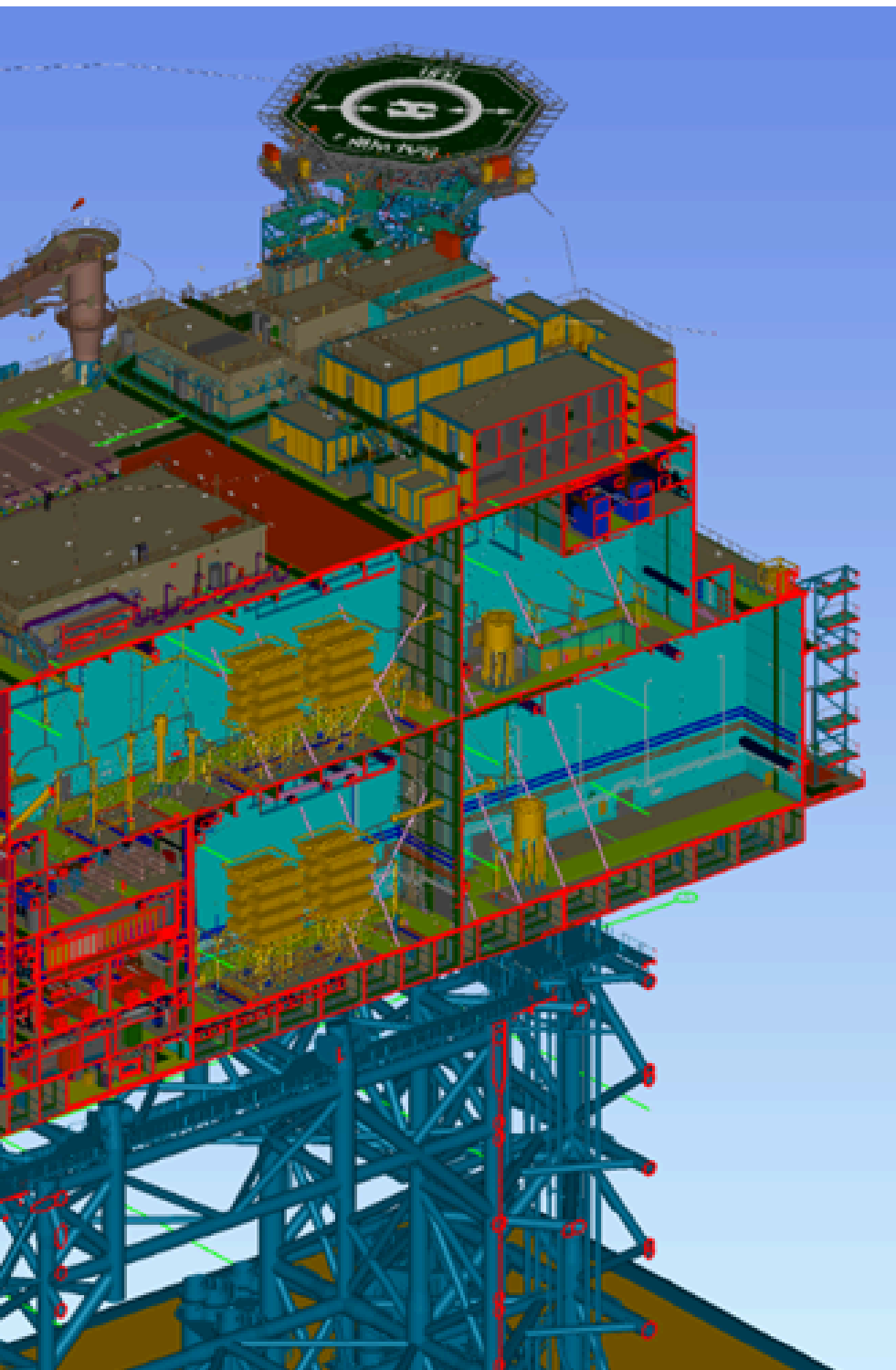

📍 Client: Oil Tanking Ebytem S.A.  
📍 Location: Puerto Rosales  
🌐 Country: Argentina

Development of Basic Engineering for the Jetty Expansion of the Oil Tanking Ebytem S.A. Storage Terminal, Puerto Rosales, Argentina.

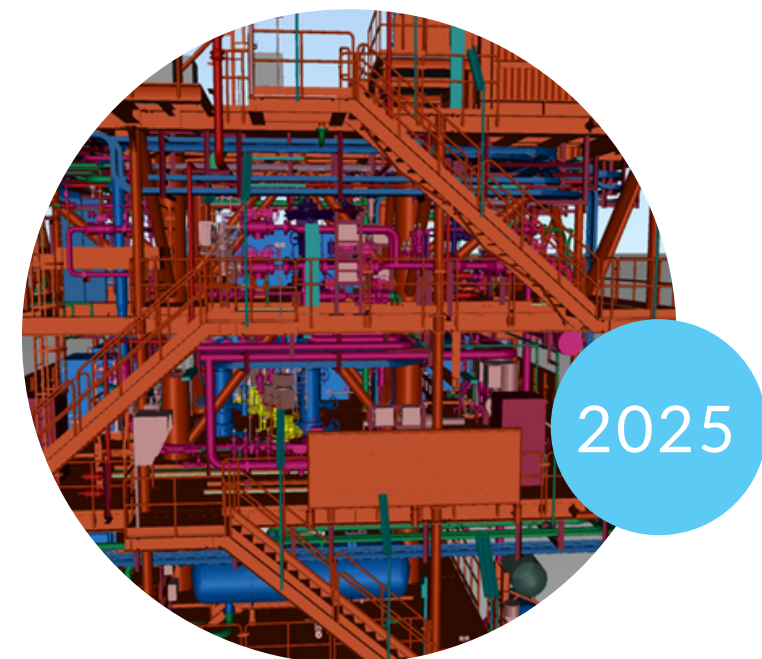

📍 Client: COMMSA / ENI  
📍 Location: Tampico, Tamps.  
🌐 Country: Mexico

Update of As-Built Drawings and 3D Model for the AMOCA WHP2 and TECOALLI Platforms for COMMSA / ENI



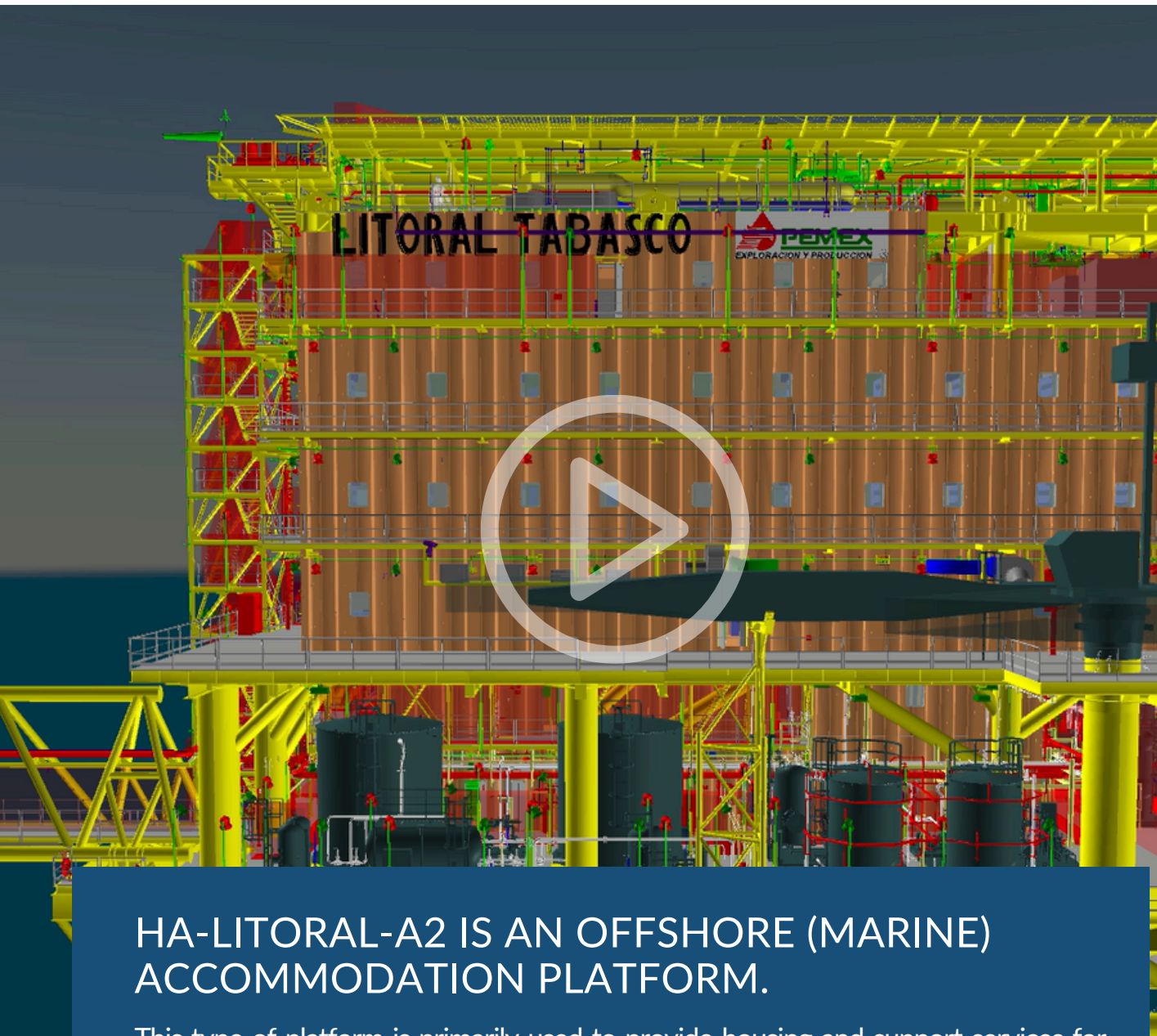

## HA-LITORAL-A2 IS AN OFFSHORE (MARINE) ACCOMMODATION PLATFORM.

This type of platform is primarily used to provide housing and support services for technical and operational personnel working in offshore hydrocarbon extraction and production fields.

The technical disciplines involved in this project included Structural, Piping, Process, Electrical, Instrumentation, HVAC, and Architecture.

This platform was fully modeled using AVEVA PDMS – Multidisciplinary 3D Modeling, while the official 2D documentation was developed using the AVEVA DRAFT module, based on AVEVA PDMS version 12.1.

For model visualization and rendering, Autodesk NAVISWORKS was used.

## Engineering Design and 3D Modeling Proficiency

Expertise is maintained in AVEVA E3D/PDMS, CADWorx, AutoCAD Plant 3D, and Tekla. Complex requirements are translated into constructible models, where all engineering disciplines are integrated from the project's inception.

The 3D model is established as the Single Source of Truth, ensuring that interferences and inconsistencies are eliminated, and a coherent design—optimized for fabrication—is guaranteed.

## Core Platforms and 3D Modeling Expertise in AVEVA

The firm's capacity is backed by a track record of high-complexity executions:



### 13 Complete OFFSHORE Platforms (2019–2022):

Modeling was executed in AVEVA PDMS for ESEASA OFFSHORE. Civil-Structural, Electromechanical, and Architectural disciplines were fully integrated.

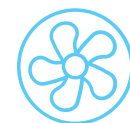

### HVAC Systems for 2-GW HVDC PLATFORMS (2024–2025):

Performed for DRAGADOS OFFSHORE (Spain). Modeling was conducted remotely from our Tampico, Mexico offices using AVEVA E3D for the BALWIN 1, BALWIN 2, and LAWIN 2 projects.



### Fuel Storage and Transfer Terminal - Puerto Rosales, Argentina (2023–2025):

Developed for Oiltanking Ebytem, S.A. Eight tanks, each with a capacity of 315,000 barrels (~50 million liters each), were developed, resulting in a total storage capacity of over 2.5 million barrels and a multi-channel jetty capable of three simultaneous loading/unloading operations. The project was executed using a precise, multidisciplinary 3D model.



# Technical and Operational Differentiators



## Robust and Validated Component Libraries

Specialized libraries are utilized to accelerate efficient, code-compliant design. These assets serve as the foundation for the precise and automated extraction of shop data, including Bills of Materials (BOM) and isometrics.



## Scalable Capacity and Consolidated Expertise

A core team of nine Senior Modelers is managed by an Administrative Coordinator. An immediate production capacity exceeding 22,000 specialized modeling man-hours is maintained, with the flexibility to reassign five additional modelers based on demand.



## High-Performance Infrastructure and Security

Operations are supported by a robust technological platform featuring 350 MB internet, Fixed IP (on demand), high-performance servers, and modern workstations with dual-monitor setups. Productivity, security, and data integrity are further ensured through corporate-grade antivirus and automated backup systems.

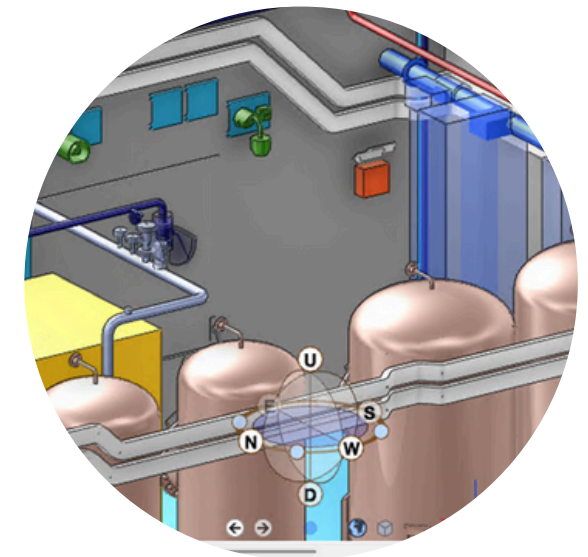
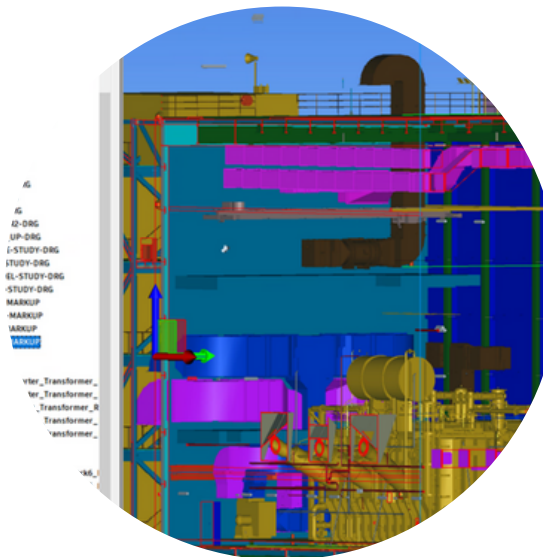
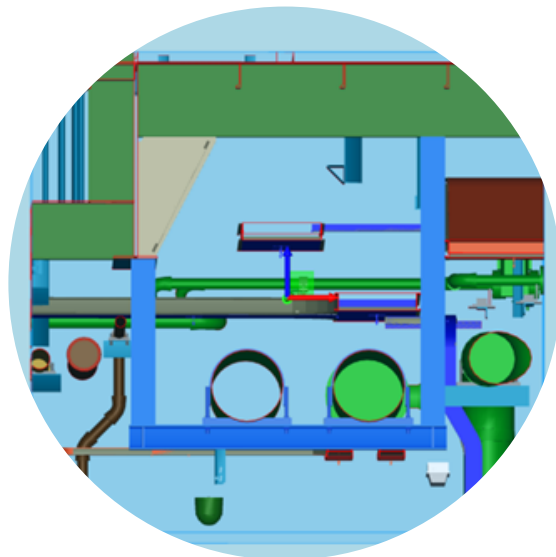

## Summary of Value

An industrialized process is offered, supported by proven digital assets and a team dedicated to the delivery of predictable, efficient, and fully constructible projects.





## CONTACT US

+52 833 126 1666  
+52 833 274 2964  
[www.gowservices.com](http://www.gowservices.com)

Human Resources  
[claudia.lopez@gowservices.com](mailto:claudia.lopez@gowservices.com)

Engineering Projects  
[eporras@gowservices.com](mailto:eporras@gowservices.com)

Commercial Manager  
[gvasquez@gowservices.com](mailto:gvasquez@gowservices.com)

---